

■ **Specifications**

Current rating:2.0AAC/DC
Voltage rating:125V AC/DC
Contact resistance:20m ohm. max.
Insulation resistance:1000M ohm. Min.
Withstanding voltage:500V AC for one minute
Operating temperature range:-40°C to +105°C

■ **Material and Finish**

Insulator:High Temp. Plastic(UL94V-0)
Contact:Copper Alloy
Plating:Selective Gold Plated

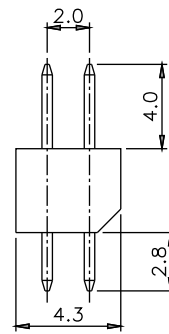
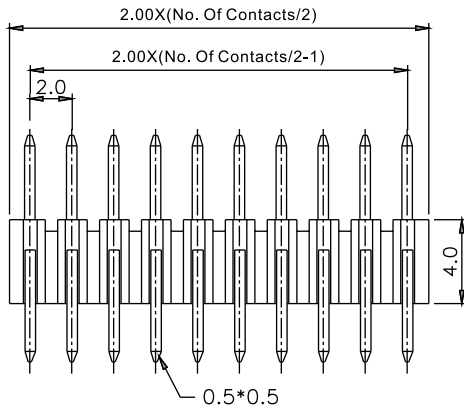

P/N:2204S-XXSG

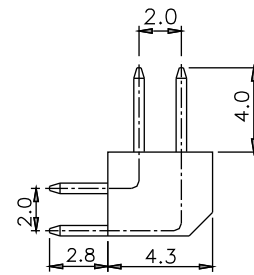

P/N:2204R-XXSG

■ **Ordering Information**

2204S-XXSG

① ② ③

① S: Straight Type R: Right Angle Type	② No. Of Contacts ③ SG: Selective Gold
-------------------------------------------	-------------------------------------------

■ **Recommended PCB Layout**

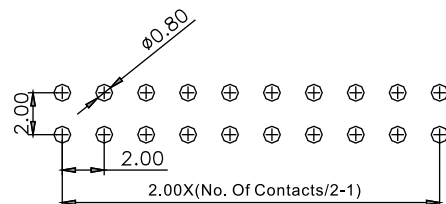

Unit:mm