

■ **Specifications**

Current rating:2.0AAC/DC
Voltage rating:125V AC/DC
Contact resistance:20m ohm. max.
Insulation resistance:1000M ohm. Min. At 100V DC
Withstanding voltage:500V AC for one minute
Operating temperature range:-40°C to +105°C

■ **Material and Finish**

Insulator:High Temp. Plastic(UL94V-0)
Contact:Phosphor Bronze
Plating:Gold/Selective Gold Plated

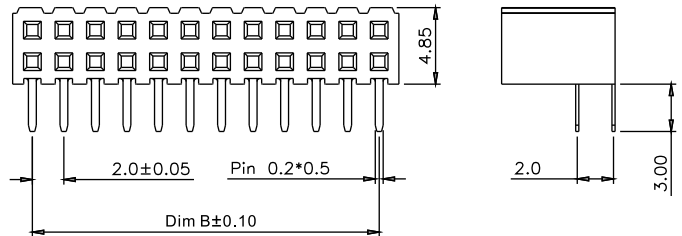
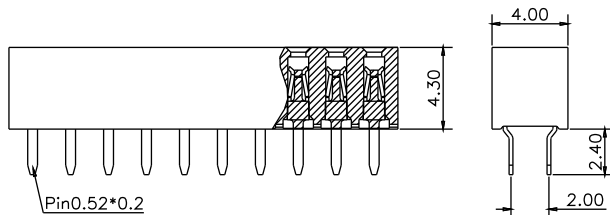
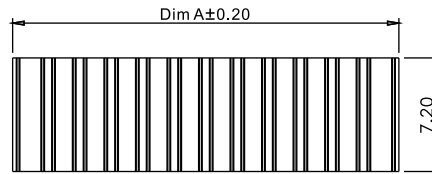
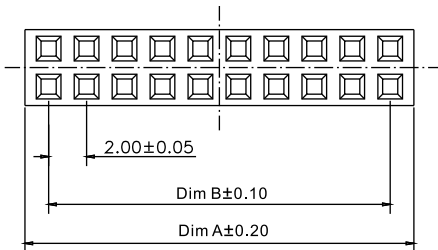

P/N:2207S-XXSG

P/N:2207R-XXG

■ **Engineering Dimension**

Circuits	Dim. A	Dim. B	Circuits	Dim. A	Dim. B	Circuits	Dim. A	Dim. B	Circuits	Dim. A	Dim. B
4	4.50	2.00	24	24.50	22.00	44	44.50	42.00	64	64.50	62.00
6	6.50	4.00	26	26.40	24.00	46	46.50	44.00	66	66.50	64.00
8	8.50	6.00	28	28.30	26.00	48	48.50	46.00	68	68.50	66.00
10	10.50	8.00	30	30.20	28.00	50	50.50	48.00	70	70.50	68.00
12	12.50	10.00	32	32.10	30.00	52	52.50	50.00	72	72.50	70.00
14	14.50	12.00	34	34.00	32.00	54	54.50	52.00	74	74.50	72.00
16	16.50	14.00	36	35.90	34.00	56	56.50	54.00	76	76.50	74.00
18	18.50	16.00	38	37.80	36.00	58	58.50	56.00	78	78.50	76.00
20	20.50	18.00	40	39.70	38.00	60	60.50	58.00	80	80.50	78.00
22	22.50	20.00	42	41.60	40.00	62	62.50	60.00			

■ **Recommended PCB Layout**

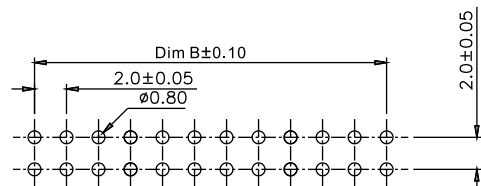

■ **Ordering Information**

2207S-XXSG

① ② ③

① S: Straight Type	② No. Of Contacts
	③ SG: Selective Gold Plated

2207R-XXG

① ② ③

① R: Right Angle Type	② No. Of Contacts
	③ G: Gold Plated

Unit:mm