

■ **Specifications**

Current rating:3.0AAC/DC
Voltage rating:250V AC/DC
Contact resistance:20m ohm. max.
Insulation resistance:1000M ohm. Min.
Withstanding voltage:600V AC for one minute
Operating temperature range:-40°C to +105°C

■ **Material and Finish**

Insulator:High Temp. Plastic(UL94V-0)
Contact:Phosphor Bronze
Plating:Gold Plated

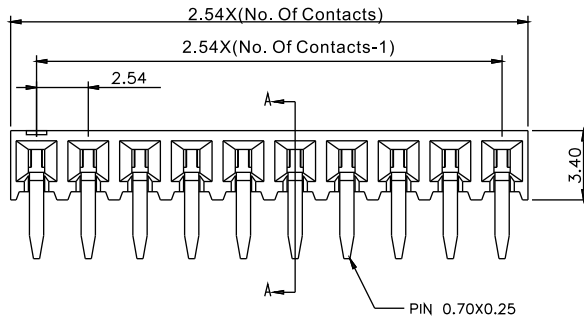

P/N:2212BR-XXG

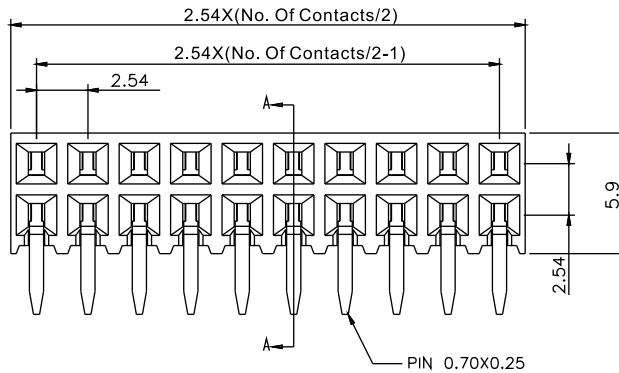
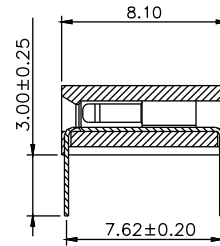

P/N:2214BR-XXG

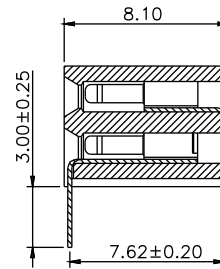

■ **Ordering Information**

2212BR-XXG

① ② ③

① 2212: Single Row 2214: Double Rows	② No. Of Contacts	③ G: Gold Plated
---	-------------------	------------------

■ **Recommended PCB Layout**

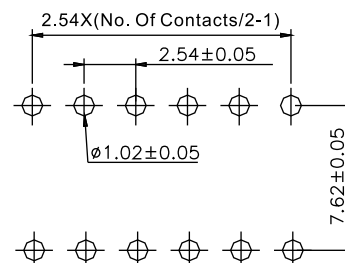

Unit:mm